

Order No. R800 8100 00



The Radial SW8™ is an 8-channel redundant backup switching interface designed for live concert touring and stage shows that employ pre-recorded backing tracks as part of the sound production. The SW8 provides the means to switch to a backup multi-track machine if ever the main unit should suffer a failure. Switching from one multi-track to another is instantaneous and noiseless enabling the show to go on uninterrupted.

The SW8 works by switching two balanced 8-channel line inputs between one 8-channel thru-put. For flexibility, the SW8 thru-puts both line-level and mic-level signals. This makes it easy to interface the SW8 at the mix-position using its line-level thru-put, or on-stage using the transformer isolated XLR direct box outputs to feed mic-level signals to a snake.

To accommodate larger 16 or 24 track playback, the SW8 is equipped with a link function that allows several units to be slaved together. The SW8 can be manually switched by the front panel AB selector or footswitch. Automatic switching is performed by sensing a pre-recorded drone track from the master multi-track. Should the drone disappear the SW8 will seamlessly switch to the backup multi-track.

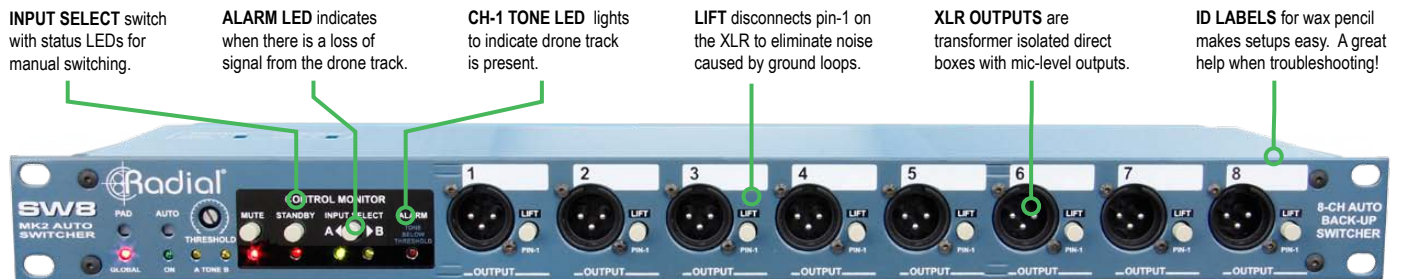

INPUT SELECT switch with status LEDs for manual switching. **ALARM LED** indicates when there is a loss of signal from the drone track. **CH-1 TONE LED** lights to indicate drone track is present. **LIFT** disconnects pin-1 on the XLR to eliminate noise caused by ground loops. **XLR OUTPUTS** are transformer isolated direct boxes with mic-level outputs. **ID LABELS** for wax pencil makes setups easy. A great help when troubleshooting!

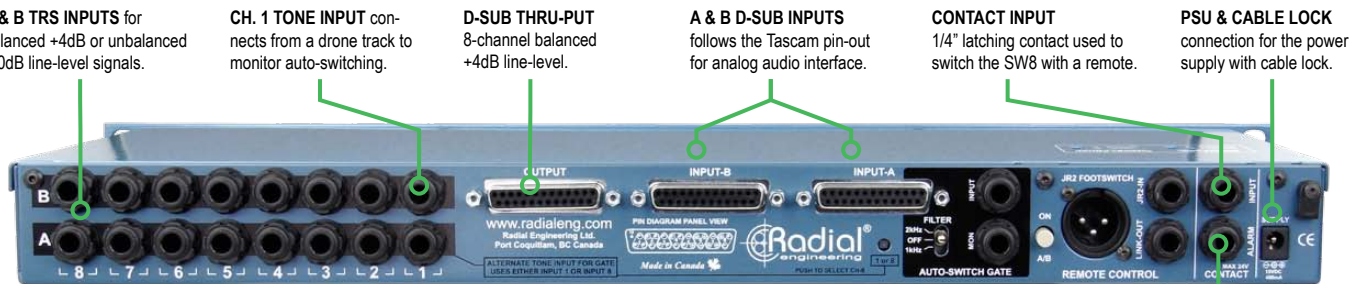

A & B TRS INPUTS for balanced +4dB or unbalanced -10dB line-level signals. **CH. 1 TONE INPUT** connects from a drone track to monitor auto-switching. **D-SUB THRU-PUT** 8-channel balanced +4dB line-level. **A & B D-SUB INPUTS** follows the Tascam pin-out for analog audio interface. **CONTACT INPUT** 1/4" latching contact used to switch the SW8 with a remote. **PSU & CABLE LOCK** connection for the power supply with cable lock.

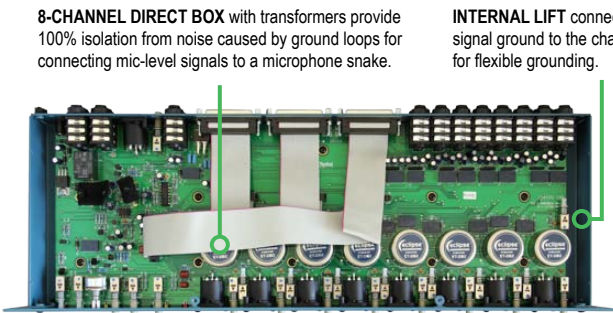

8-CHANNEL DIRECT BOX with transformers provide 100% isolation from noise caused by ground loops for connecting mic-level signals to a microphone snake.

INTERNAL LIFT connects the signal ground to the chassis for flexible grounding.

FILTER lets you use a binary signal such as SMPTE as a drone track by smoothing out the signal. **ALT 1/8** selects between channel 1 or 8 to receive the drone track.

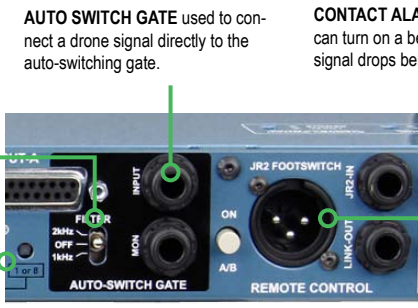

AUTO SWITCH GATE used to connect a drone signal directly to the auto-switching gate.

CONTACT ALARM internal relay can turn on a beacon when the drone signal drops below the set threshold.

JR-2 used to connect optional JR-2 remote to switch between A & B inputs. Link multiple SW8's together with one footswitch.

Detail of rear panel controls.

SW8 at Front of House Position

Multi-track machines connect to the SW8 using either the 25-pin D-Sub or 1/4" Phone inputs. When the SW8 is located at the FOH mix-position the 25-pin D-sub THRU-PUT connector provides a direct balanced line-level feed from the multi-track to the console.

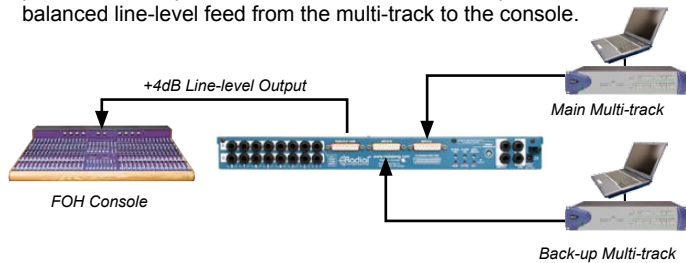

SW8 On-stage

When the SW8 is located on-stage the eight, transformer isolated, XLR direct box outputs are used to connect to the snake systems.

