

Order No. R800 1037 00



The Reamp Station combines two studio essentials in one complete package: an active direct box for capturing pristine recordings of any instrument, and the JCR high-performance Reamper to feed your tracks to guitar pedals and amplifiers for re-recording, to take your mixes to another level.

The active DI portion of the Reamp Station is based off of Radial's world-class J48, tweaked slightly to provide maximum benefit for recording tracks that can be Reamped later on. Among these changes is a buffer switch, which engages a unity-gain Class-A buffered circuit on the Thru output, preventing any loading down of passive pickups when connected to an amplifier and preserving the natural tone of your instrument.

The Reamper side of the device takes the circuit from the Reamp JCR, originally designed by acclaimed engineer John Cuniberti, and ports it into a multi-use studio tool. The JCR features a custom-wound 'Made in the USA' transformer to convert the line-level signals from an audio interface so they are optimized to feed guitar pedals and amplifiers, while also including a level control, 3-position filter, and a mute switch to protect your ears when adjusting mic placement on a live amp. In addition to the XLR and balanced 1/4" TRS inputs for the Reamper, a 3.5mm mini input is also included for easy connection to mobile devices such as smartphones and tablets to streamline playback and encourage additional creativity.

Features

- Combination Direct Box & Studio Reamper
- Active DI for clean, detailed recordings
- JCR Reamp circuit with transformer isolation
- Reamp level control, filter & mute switches

Applications

- Record guitar and bass through the DI
- Re-amplify signals through pedals and amps
- Explore new tones & recording techniques
- Use your pedal collection as outboard FX

Benefits

- A complete recording & Reamping solution
- Make your mixes stand out
- Daisy-chain multiple units to feed extra amps
- Explore endless combinations and FX

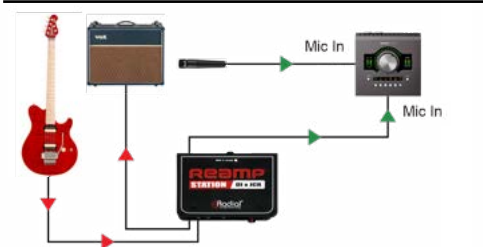
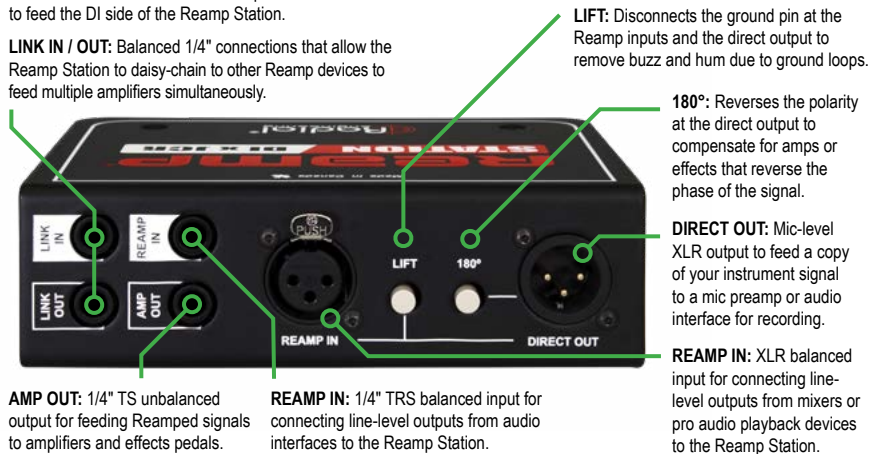
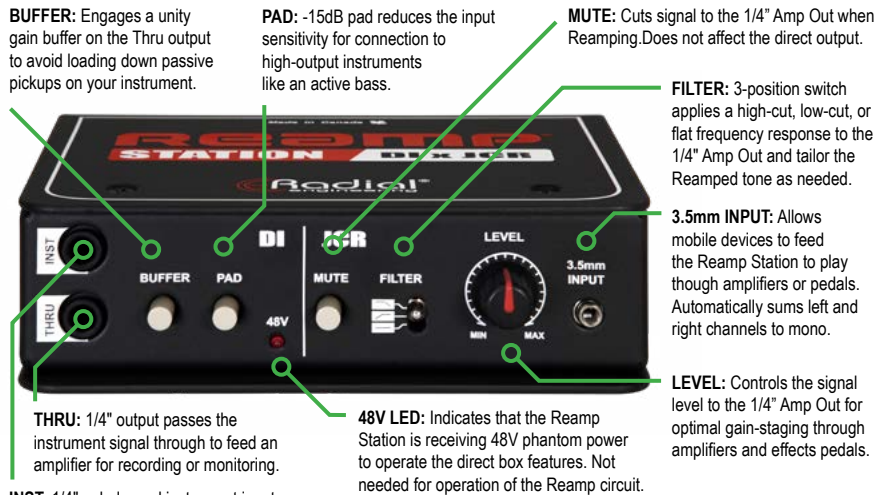

Reamping Pt 1: Recording Direct

Recording a clean, noise-free 'dry' track is an essential step in studio Reamping. The active DI in the Reamp Station captures your instrument signal without coloration or distortion, providing the perfect template for future tweaking. A Thru output feeds a guitar amp for monitoring or mic'd up recording.

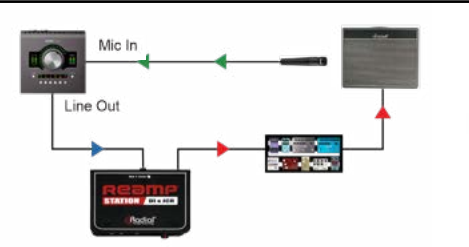

Reamping Pt 2: Back Through the Amp

Once you have your original performance recorded, you can let the real fun begin. Feed your pre-recorded track back through your pedals and amps and experiment with new and exciting tonal combinations, taking your time to make adjustments and find the perfect balance without tiring out your guitar players fingers.

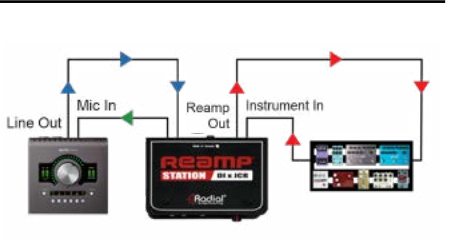

Record through Effects Pedals

With the Reamp Station, you can play any recorded track back through your effects pedals as if they were a piece of studio hardware. Send the Reamped signal out to your pedals as normal, but skip the amplifier and connect back into the Reamp Station's instrument input. The direct box output feeds a mic-level signal back to your interface to record the results.