

## FEATURES AND FUNCTIONS

- ① **INPUT-1** - ¼" jack for first instrument connection.
- ② **INPUT-2** - ¼" jack for second instrument connection.
- ③ **OUTPUT** - ¼" jack connects to amplifier.
- ④ **TUNER** - ¼" jack connects to tuner.
- ⑤ **9VDC** - power jack connection for power supply (for LED's only).
- ⑥ **TUNER** - switch determines whether the TUNER output is on all the time or only when MUTE footswitch is depressed.
- ⑦ **TRIM** - bypass switch for the TRIM level control.
- ⑧ **INPUT-2 LEVEL** - control lets you reduce the level of the instrument connected to INPUT-2.
- ⑨ **BRIGHT** - three position switch counteracts any effects from the TRIM LEVEL control circuit and the capacitive filtering effects from long cables.
- ⑩ **MUTE** - footswitch with LED turns the OUTPUT jack off for silent on-stage tuning through the TUNER output.
- ⑪ **SELECT** - footswitch with LED indicator toggles between INPUT-1 and 2 to select the desired instrument.



## IMPORTANT NOTICE!



The Radial BigShot i/o is a passive switcher that is specifically designed for use with amplifiers with proper electrical safety grounds that have been approved by nationally recognized electrical authorities such as UL in the United States, CSA in Canada and other similar bodies in countries around the world.

It is further understood that due to the unpredictable nature of connecting any number of different amplifiers and pedals together, using the BigShot i/o can pose a potential for electric shock, and as such, the user is completely responsible for any and all consequences as these are beyond our control.

This means that you are completely responsible to ensure the safe and proper use of the BigShot i/o and to clearly understand that using the BigShot i/o confirms you have taken full responsibility. If you are not 100% sure of your actions, please consult a qualified technician for advice before using this device or connecting any of your equipment to it.

## RADIAL LIMITED THREE YEAR TRANSFERABLE WARRANTY

RADIAL ENGINEERING LTD. ("Radial") warrants this product to be free from defects in material and workmanship and will remedy any such defects free of charge according to the terms of this warranty. Radial will repair or replace (at its option) any defective component(s) of this product (excluding finish and wear and tear on components under normal use) for a period of three (3) years from the original date of purchase. In the event that a particular product is no longer available, Radial reserves the right to replace the product with a similar product of equal or greater value. To make a request or claim under this limited warranty, the product must be returned prepaid in the original shipping container (or equivalent) to Radial or to an authorized Radial repair center and you must assume the risk of loss or damage. A copy of the original invoice showing date of purchase and the dealer name must accompany any request for work to be performed under this limited and transferable warranty. This limited warranty shall not apply if the product has been damaged due to abuse, misuse, misapplication, accident or as a result of service or modification by any other than an authorized Radial repair center.

THERE ARE NO EXPRESSED WARRANTIES OTHER THAN THOSE ON THE FACE HEREOF AND DESCRIBED ABOVE. NO WARRANTIES WHETHER EXPRESSED OR IMPLIED, INCLUDING BUT NOT LIMITED TO, ANY IMPLIED WARRANTIES OF MERCHANTABILITY OR FITNESS FOR A PARTICULAR PURPOSE SHALL EXTEND BEYOND THE RESPECTIVE WARRANTY PERIOD DESCRIBED ABOVE OF THREE YEARS. RADIAL SHALL NOT BE RESPONSIBLE OR LIABLE FOR ANY SPECIAL, INCIDENTAL OR CONSEQUENTIAL DAMAGES OR LOSS ARISING FROM THE USE OF THIS PRODUCT. THIS WARRANTY GIVES YOU SPECIFIC LEGAL RIGHTS, AND YOU MAY ALSO HAVE OTHER RIGHTS, WHICH MAY VARY DEPENDING ON WHERE YOU LIVE AND WHERE THE PRODUCT WAS PURCHASED.

## BigShot i/o Owner's Manual



**CAUTION: PLEASE READ THE IMPORTANT NOTICE ON THE BACK COVER BEFORE USING THE BIGSHOT i/o**

Radial Engineering Ltd.  
#1165 - 1845 Kingsway Ave,  
Port Coquitlam BC V3C 1S9  
Tel: 604-942-1001 • Fax: 604-942-1010  
Email: info@radialeng.com

www.radialeng.com

**CONGRATULATIONS** on your purchase of a Radial BigShot i/o. The BigShot i/o is a foot controllable device that allows a musician to select between two instruments on stage. The BigShot i/o can select between an electric and acoustic guitar or between a passive 4-string bass and an active-5 string bass. This is done by simply depressing a footswitch.

To make the transition as simple and effective as possible, an innovative LEVEL control is provided that only affects INPUT-2. This control allows the louder of the two instruments to be tamed down so that both instruments play through the same amp channel at the same relative volume. The LEVEL control may be switched out of the signal path when not needed. Bright and easy to see LED's indicate the active input and mute status when the unit is connected to a power supply.

To add versatility, a second output labeled TUNER allows a tuning device to be connected for quiet on-stage tuning. The BigShot i/o is ideally suited for any high impedance instrument such as guitars, basses and keyboards.

#### CONNECTING THE BIGSHOT I/O

To power the LED's, the BigShot i/o requires an external 9VDC Boss style power supply wired center pin negative. Before making any connections, confirm your amplifier is turned off and the volume controls are turned all the way down. This will reduce the possibility of problems should you have a short or a bad connection.

Start by connecting your main guitar to INPUT-1 and your second guitar to INPUT-2. Now connect the OUTPUT to your amplifier. If you have a tuner, you can connect it to the TUNER output.

Turn your amp on and test your setup at a low volume. By depressing the SELECT footswitch, you will be able to toggle between guitars. By depressing the MUTE footswitch, you will turn off the output for silent tuning. You are now set to go!

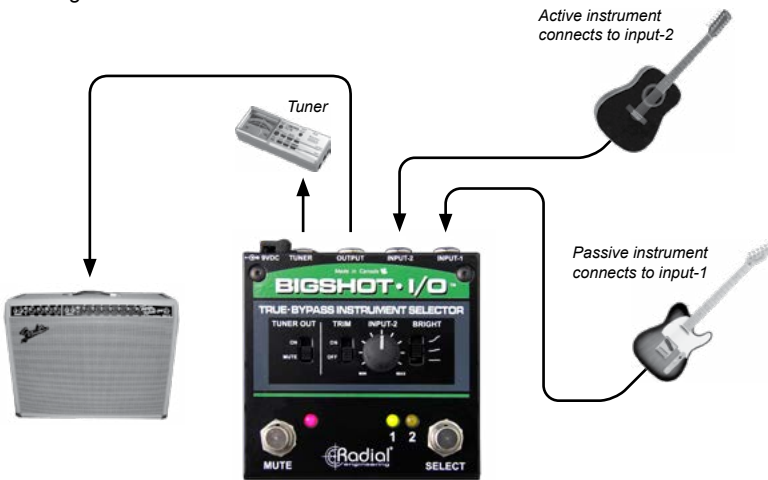

#### USING THE RADIAL BIGSHOT I/O

##### TRIM LEVEL

The BigShot i/o is equipped with an innovative feature called TRIM LEVEL. By engaging the TRIM LEVEL control, you can reduce the level of the instrument connected to INPUT-2 so that it matches the instrument connected to INPUT-1. Using the TRIM LEVEL control to set a balanced level between two instruments can make transitions quick and easy without having to go to the amp and adjust the level each time.

TRIM LEVEL is designed primarily for situations when toggling between an instrument with passive pickups (such as a vintage Fender Precision bass) and an instrument with active pickups (such as a modern 5 string bass). The active bass will generally have much more output than the passive. The same logic applies when toggling between an electric guitar with passive pickups and an acoustic guitar with a built in preamp. The active acoustic guitar is much louder than the passive electric. By reducing the output of the more powerful instrument with the TRIM LEVEL control, toggling between instruments during a hectic show is greatly simplified.

To use the TRIM LEVEL control, first ensure the TRIM slider switch is in the on position. Next connect the louder of your two instruments to INPUT-2. Strum each guitar and use the SELECT footswitch to toggle between instruments. Adjust the TRIM LEVEL control until the instrument levels match.

##### TRIM SWITCH

The TRIM LEVEL control would generally not be used if you are selecting between two identical guitars, such as a backup guitar. It may be switched out of the circuit using the TRIM slider switch.

##### BRIGHT SWITCH

This 3 position switch is designed to counteract any effects caused by the TRIM LEVEL control and therefore only affects the instrument connected to INPUT-2. As the BigShot i/o is passive, introducing a potentiometer into the circuit could darken the tone in some cases. The BRIGHT switch will allow you to compensate as needed. Note that the BRIGHT switch is only available when the TRIM switch is set in the on position.

##### TUNER SWITCH

The TUNER slider switch works with the MUTE footswitch and controls how the TUNER output jack behaves. In the down position, the TUNER output jack is only active when the MUTE footswitch is depressed, this also mutes the main OUTPUT for silent on-stage tuning. In the up position, the tuner output remains on at all times regardless of whether the main OUTPUT is muted or not. This allows on-the-fly tuning.

##### MUTE FOOTSWITCH

The MUTE footswitch on the BigShot i/o always turns off the main OUTPUT jack and stops your guitar signal from reaching the amplifier.

##### SELECT FOOTSWITCH

The SELECT footswitch determines which input jack is active and toggles between them.

#### FAQ

**Besides guitar and bass, can the BigShot i/o be used with other instruments?**

Yes. The BigShot i/o will work for any high impedance signal including electronic instruments like keyboards and samplers. It will also work with dynamic microphones that have a hi-Z ¼" cable. For low-Z balanced mics, use the Radial HotShot ABi device which is designed to switch mic signals.

**What is the advantage to turning the tuner output off?**

Splitting the guitar signal to feed two inputs such as the tuner and amplifier can cause passive pickups to be loaded down. Loading will reduce the level of your guitar signal and make it sound less punchy. The BigShot's tuner mute feature eliminates loading problems and has the benefit of convenient silent tuning.

**Can I use the tuner output to switch between amps like an ABY switcher?**

Yes, but be careful! Especially with older amps that do not have safety grounds. These old amps are notorious for causing shocks! As such, we are unable to recommend this practice due to legal responsibility. Please consult a qualified technician should you wish to use your BigShot i/o in an application it was not intended for.

**I hear a slight clicking when I switch in effects. Is this normal?**

Yes. The BigShot i/o is passive and the click occurs as the switch makes contact. This is normal for passive devices like the i/o. The only switchers that do not click are the types that employ photocells like the Tonebone Bassbone. These units ramp up and down the signal to avoid the on-off click.

**What is the difference between the BigShot i/o and the Tonebone Bassbone?**

Both allow you to select between two instruments but the BigShot i/o is passive while the Bassbone is a preamp and employs active Class-A buffering. The BigShot i/o is designed for those that prefer a direct guitar to amp connection. The Bassbone is designed for those that need to run longer cables, insist on eliminating all switching noises and do not want to deal with loading issues. The i/o is also considerably more affordable!

**I have two passive instruments. Which one do I connect to INPUT-2?**

Even passive pickups can vary in the amount of signal they produce. Connect the "louder" of the two instruments to INPUT-2 and use the TRIM LEVEL control to match levels between instruments. If necessary, the BRIGHT switch may be employed to compensate for any treble loss as a result of the TRIM LEVEL control. If your instruments are identical and no level matching is needed, the TRIM switch should be in its off position.

**I have two guitars, one going direct and another I use with a wireless. How do I connect them to the BigShot i/o?**

The wireless system will have a buffer or pre-amplifier as part of its output stage. This makes it very much like an active instrument. Connect the passive guitar to INPUT-1 for a true bypass connection to your amp. Connect the wireless to INPUT-2 and use the TRIM LEVEL control to match levels between instruments.